

PRE-INSULATED ALUMINIUM CONNECTOR

Pre-insulated connectors are used for the connection of LV aerial bundle cable (ABC) conductors to each other. The models offered below are specific for the LV phase and neutral cables sizes used in Malaysia.

MJPB pre-insulated connectors are designed for service and lighting cables.

MJPT is for phase conductor and designed for LV-ABC system with neutral messenger.

MJPTN is used on neutral conductor and designed for LV-ABC system with neutral messenger



MJPB16/16



MJPT95/95



MJPTN25/25



MJPTN70/70

Main features:

- Material: Al \geq 99.5%
- Insulation sheath is made of weather and UV resistant material.
- Clear markings on insulation sheath to indicate crimping die, crimping sequence and times, cross-section of conductor and stripping length.
- Cross-section of conductor can be easily identified by the color of elastomeric cap.
- Elastomeric caps and pre-filled silicone grease ensure superior waterproof.
- Stripping of cable insulation is required before insertion.
- Tested by di-electrical voltage of 6Kv for 1 minute under water.
- Comply to standard: EN 50483-4, NFC 33-021

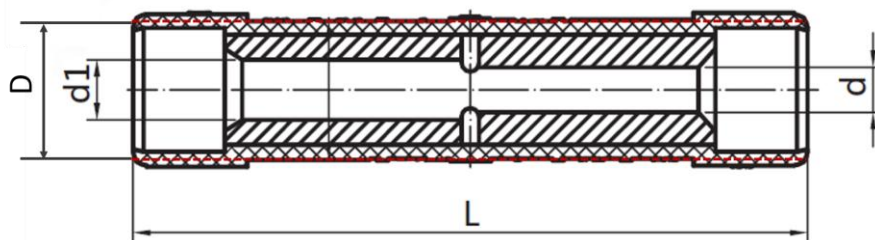

Model	Item Code	Conductor Size (mm ²)	Dimension (mm)				Color Code	Pack (pcs)	Crimping Die
			L	d	D	d1			
MJPB16/16	JMJP-MJPB16/16	16	74	5.3	16	5.3	Blue	150 x 4	E140
MJPT95/95	JMJP-MJPT95/95	95	98.5	12.2	20	12.2	Grey	60 x 4	E173
MJPTN25/25	JMJP-MJPTN25/25	25	173.5	6.5	20	6.5	Orange	40 x 4	E140
MJPTN70/70	JMJP-MJPTN70/70	70	173.5	10.6	20	10.6	White	40 x 4	E173

Notes:

1. The above models are approved with Certificate of Product Acceptance (Sijil Guna Pakai) by TNB Malaysia.