

NON-INSULATED BLADE TERMINAL (FLAT PIN)

- 1) Material : Copper with tin plated
- 2) Brazed Seam

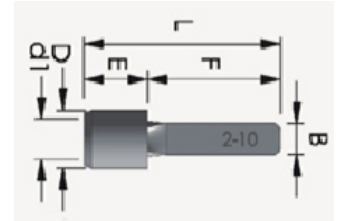

Item Code	Wire Range	Dimensions (mm)			Packing Unit
		Blade Length, F	B	L	
ITAI-BT1-10	0.5~1.5mm ² 22~16 AWG	10.5	2.3	15.5	100 pcs
		14.0	3.0	19.0	
		18.0	2.3	23.0	
ITAI-BT2-10	2.5mm ² 16~14AWG	10.5	2.3	15.5	100 pcs
		13.0	3.0	18.0	
		18.0	2.3	23.0	
ITAI-BT5-10	4~6mm ² 12~10 AWG	10.5	2.8	16.5	100 pcs
		14.0	3.0	20.0	
		18.0	3.0	24.0	

Notes:

- 1. All dimensions are in mm.