

# NON-INSULATED RING TERMINAL

- 1) Material : Copper with tin plated
- 2) Brazed Seam

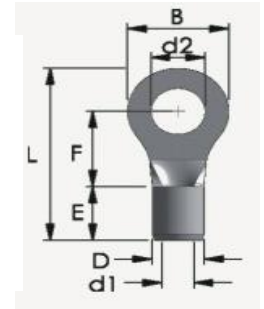

Item Code	Wire Range	d2	B	F	d1	L	Packing Unit
ITAI-R1-3S	0.5~1.5mm <sup>2</sup> 22~16 AWG	3.7	5.5	4.0	1.7	11.7	100 pcs
ITAI-R1-4S		4.3	6.6	6.3	1.7	14.6	
ITAI-R1-5		5.3	8.0	7.0	1.7	16.0	
ITAI-R1-6		6.5	11.6	11.1	1.7	21.8	
ITAI-R1-8		8.4	11.6	11.1	1.7	21.8	
ITAI-R1-10		10.5	13.6	13.9	1.7	25.7	
ITAI-R1-12		13.0	19.2	16.0	1.7	30.6	
ITAI-R2-3S	0.5~2.5mm <sup>2</sup> 16~14 AWG	3.7	6.4	4.3	2.3	12.5	100 pcs
ITAI-R2-4S		4.3	6.6	6.3	2.3	14.5	
ITAI-R2-5S		5.3	8.5	7.8	2.3	17.0	
ITAI-R2-6		6.5	12.0	11.0	2.3	22.0	
ITAI-R2-8		8.4	12.0	11.0	2.3	22.0	
ITAI-R2-10		10.5	13.6	13.9	2.3	25.7	
ITAI-R2-12		13.0	19.2	16.0	2.3	30.6	
ITAI-R5-3S	4~6mm <sup>2</sup> 12~10 AWG	3.7	7.2	5.9	3.4	15.5	100 pcs
ITAI-R5-4S		4.3	7.2	5.9	3.4	15.5	
ITAI-R5-5		5.3	9.5	8.3	3.4	19.0	
ITAI-R5-6		6.5	12.0	10.5	3.4	22.5	
ITAI-R5-8		8.4	15.0	13.7	3.4	27.2	
ITAI-R5-10		10.5	15.0	13.7	3.4	27.2	
ITAI-R5-12		13.0	19.2	16.0	3.4	31.6	

Notes:

- 1. All dimensions are in mm.