

# 'C' TYPE CONNECTOR

Use for Copper Conductor.  
Dimpled and serrated to provide high pull-out value.  
Chamfered edges design to protect the cables.

High Conductivity Copper : 99% I.A.C.S  
Copper Purity : 99.9%  
Finishing : Tin Plated Min 3-microns

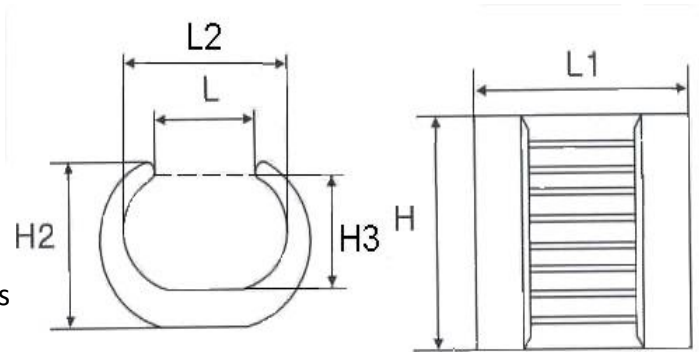

Type	Item Code	L	L1	L2	H	H2	H3	Conductor Range (mm <sup>2</sup> )
U-T44	CCUT-44	8.3	19.0	12.4	20.0	14.0	8.1	27-44
U-T60	CCUT-60	10.8	21.4	15.3	22.5	15.0	10.0	45-60
U-T76	CCUT-76	9.5	24.0	16.7	22.5	17.0	10.7	61-76
U-T98	CCUT-98	14.5	28.0	21.2	25.0	19.0	13.4	77-98
U-T122	CCUT-122	14.0	29.3	21.3	26.0	21.0	14.5	99-122
U-T154	CCUT-154	17.0	35.0	23.8	28.0	25.0	16.8	123-154
U-T190	CCUT-190	17.0	36.5	28.2	35.0	25.0	17.2	155-190
U-T240	CCUT-240	20.0	40.0	30.2	40.0	29.0	21.3	191-240
U-T288	CCUT-288	22.0	44.0	34.2	45.0	32.0	22.9	241-288
U-T365	CCUT-365	27.5	48.0	37.6	50.0	34.0	24.2	289-365
U-T450	CCUT-450	28.0	56.5	41.9	60.0	41.0	27.6	366-450

#### Notes:

1. All dimensions are in mm.



**CONWAY**  
Connecting Power

Tel : +6 03 5122 1223  
Fax : +6 03 5121 1109

Email : [ctm@conway.com.my](mailto:ctm@conway.com.my)  
Web : [www.conway.com.my](http://www.conway.com.my)